

FCL-80061AX2

Pair of Modern Silver Polished Chrome Swirl 5 x 28W Flush Ceiling Light

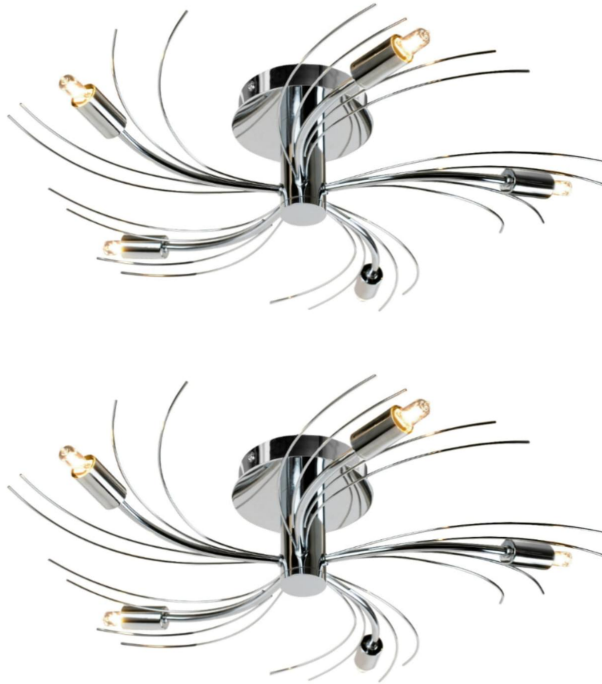

LIGHT SOURCE DATA

- 10 x 28W Max G9 Eco Halogen (required)
- Lamp direction - Indirect
- Lamp shape - Capsule
- Dimmable
- Energy class: Not applicable

DIMENSION DATA

- Height 140mm
- Diameter 450mm
- Weight 1.42kg

SPECIFICATION

- Manufacturer warranty for 2 years from date of purchase
- Polished chrome plate
- IP20
- No
- Class I - Single Insulated, Earthed
- 240V
- Assembly required? No
- CE Marking, UKCA Marking, Energy Efficient, Energy Saving

CERTIFICATION



CONTACT

www.firstchoicelighting.co.uk

info@firstchoicelighting.co.uk

FCL-80061AX2

Pair of Modern Silver Polished Chrome Swirl 5 x 28W Flush Ceiling Light

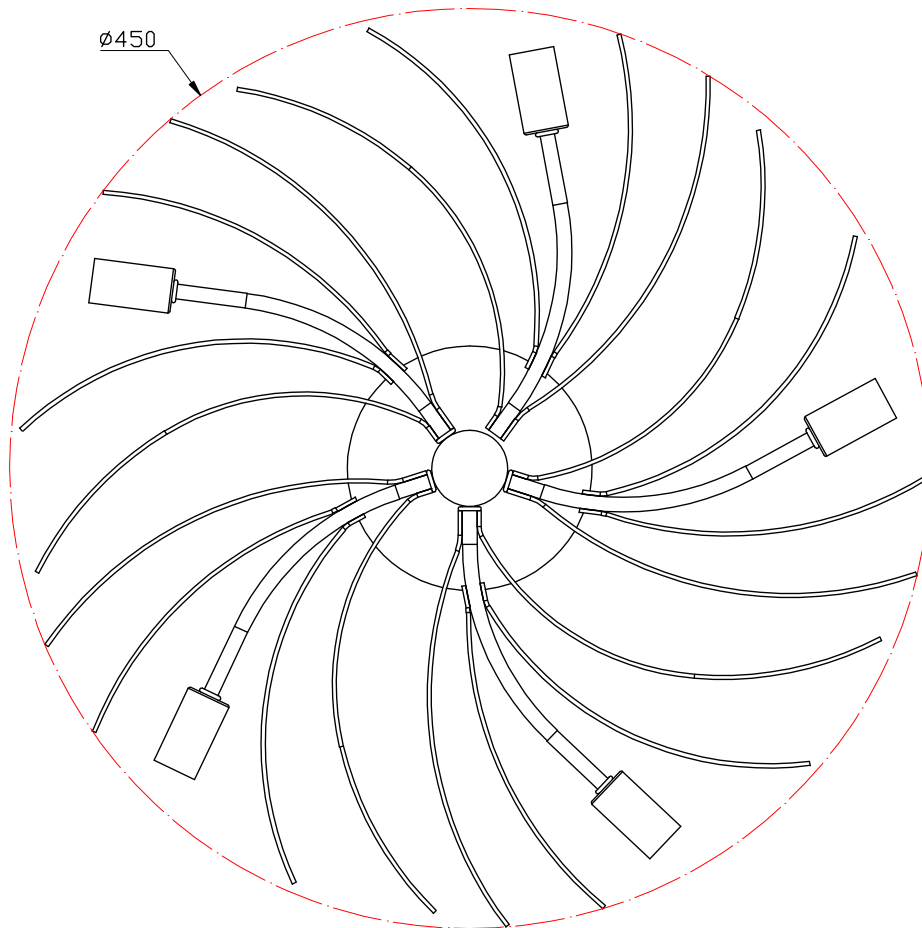
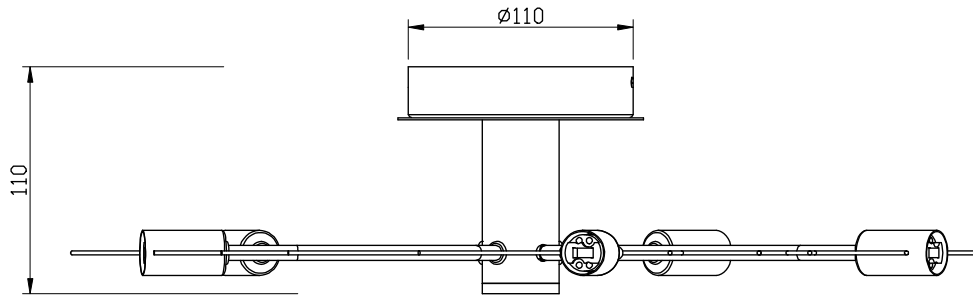

CERTIFICATION



CONTACT

www.firstchoicelighting.co.uk

info@firstchoicelighting.co.uk

ISSUE DATE 16/02/2023

PAGE 2